

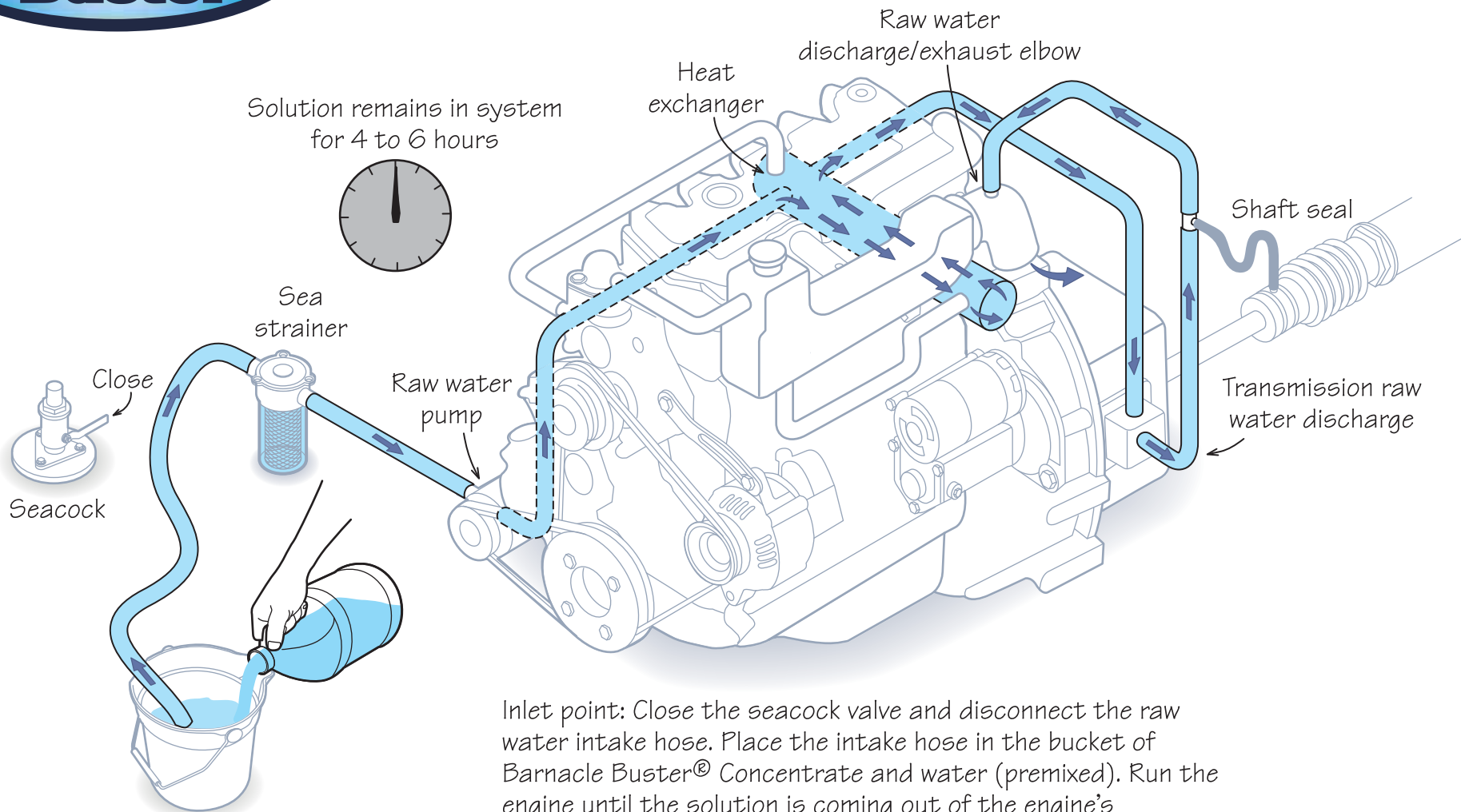

## Barnacle Buster Static Engine Flush



Pour the premixed solution of Barnacle Buster® Concentrate and water into a bucket.

Inlet point: Close the seacock valve and disconnect the raw water intake hose. Place the intake hose in the bucket of Barnacle Buster® Concentrate and water (premixed). Run the engine until the solution is coming out of the engine's overboard discharge. Secure the engine and allow the solution to work in the system for 4 to 6 hours. Finally, reconnect the raw water intake hose to the seacock, open the valve and run the engine for 5 to 10 minutes to ensure all of the Barnacle Buster® is removed from the system.