

## Raw Water Head System Cleaning with SEW Clean

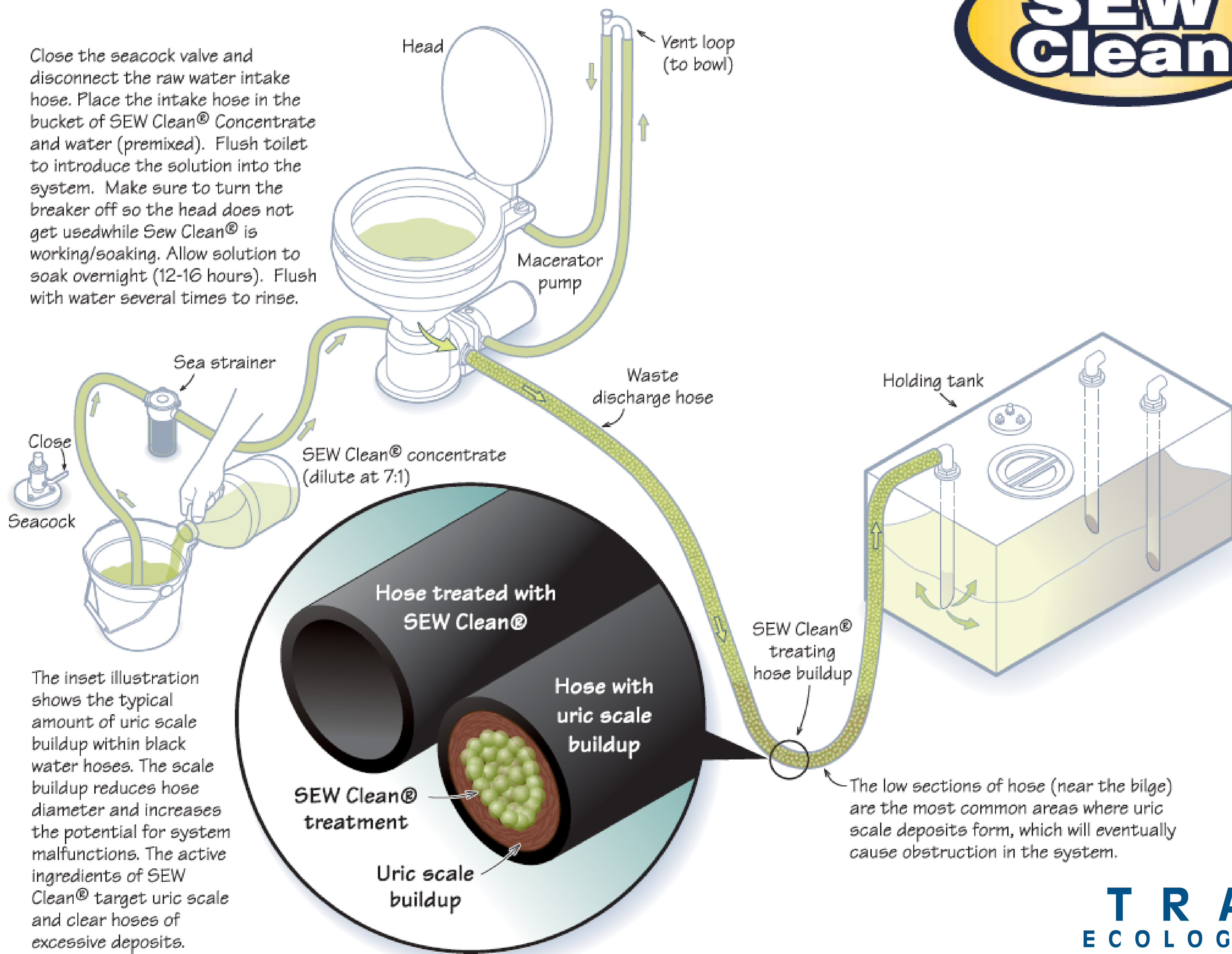

Close the seacock valve and disconnect the raw water intake hose. Place the intake hose in the bucket of SEW Clean® Concentrate and water (premixed). Flush toilet to introduce the solution into the system. Make sure to turn the breaker off so the head does not get used while SEW Clean® is working/soaking. Allow solution to soak overnight (12-16 hours). Flush with water several times to rinse.



The inset illustration shows the typical amount of uric scale buildup within black water hoses. The scale buildup reduces hose diameter and increases the potential for system malfunctions. The active ingredients of SEW Clean® target uric scale and clear hoses of excessive deposits.